



**MCAA**  
**Michigan**  
**Mud 2025**  
KALAMAZOO, MI



**POTTERY LANE**  
STUDIO & SUPPLY

## **2025 PROGRAM**

---

# WMU CAMPUS MAP



## CONTENTS

- Pg. 2-3 RCVA Building Map, 1st & 2nd Floor
- Pg. 4-5 South Kohrman Building Map, 1st & 2nd Floor
- Pg. 6-7 Friday, May 16, Full Schedule
- Pg. 8-9 Saturday, May 17, Full Schedule
- Pg. 10-13 Friday, May 16, Event Catalog and Descriptions
- Pg. 14-16 Saturday, May 17, Event Catalog and Descriptions
- Pg. 17 Sponsor List



**RCVA** SECOND FLOOR

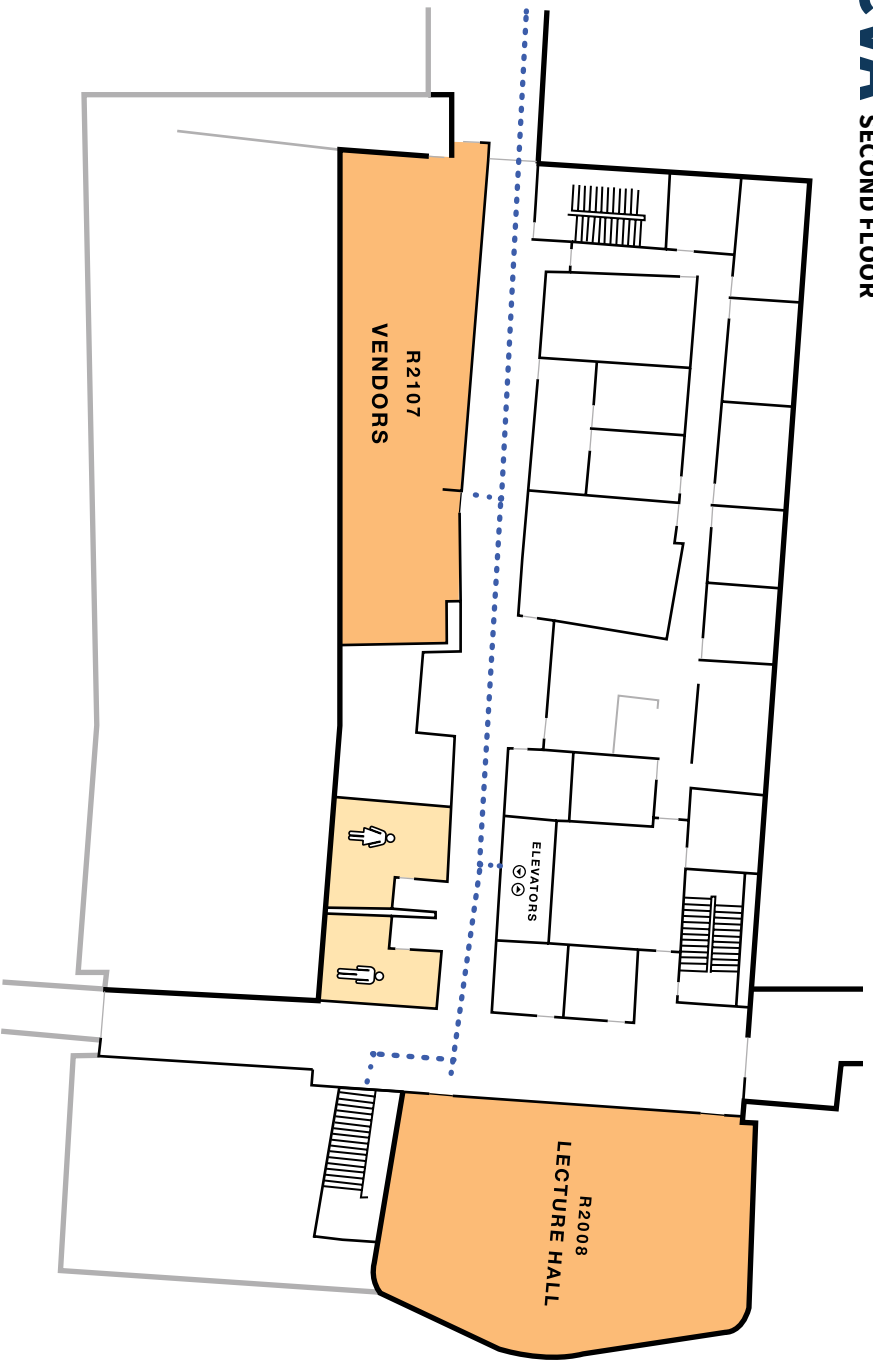

**RCVA** FIRST FLOOR

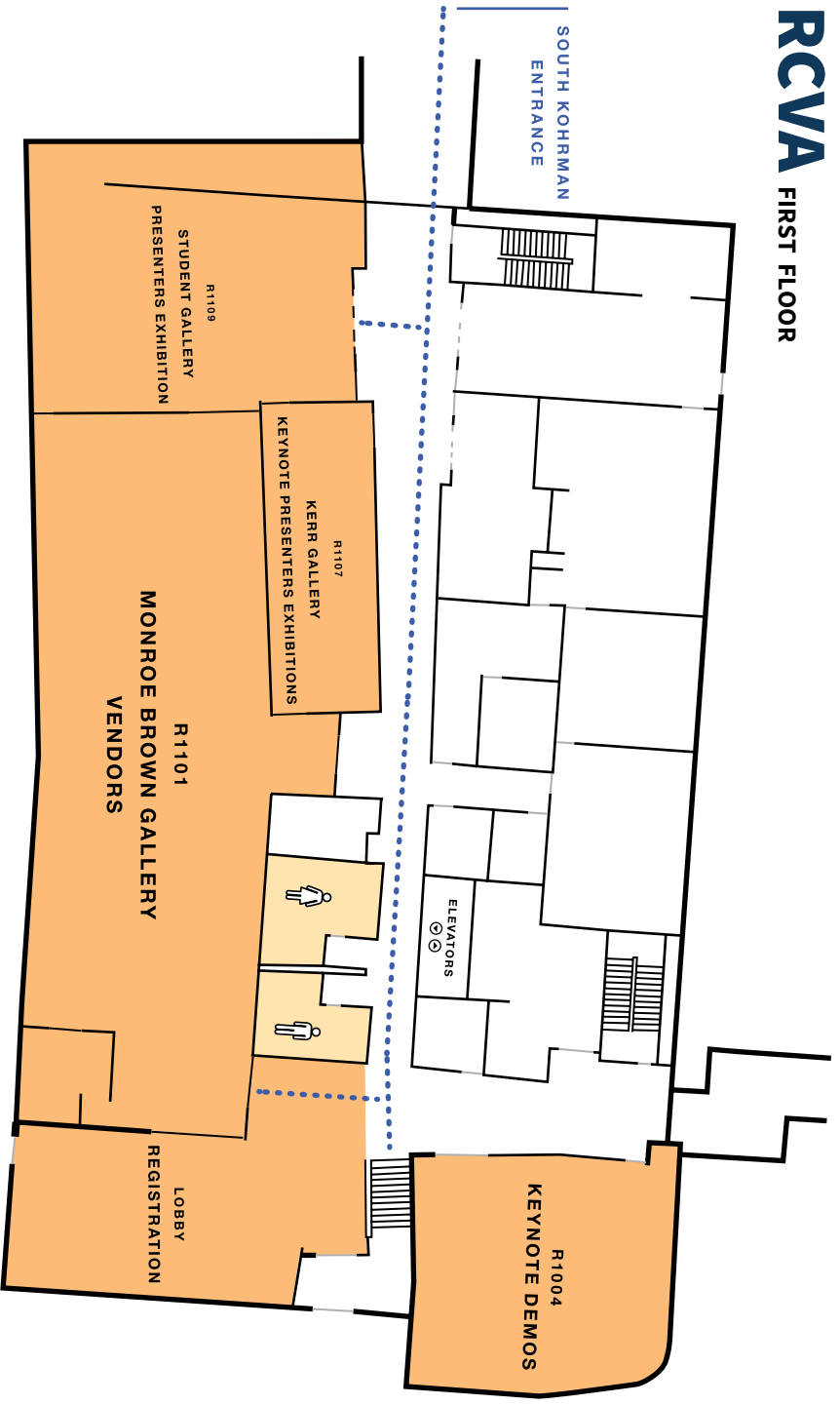

# SOUTH KOHRMAN SECOND FLOOR

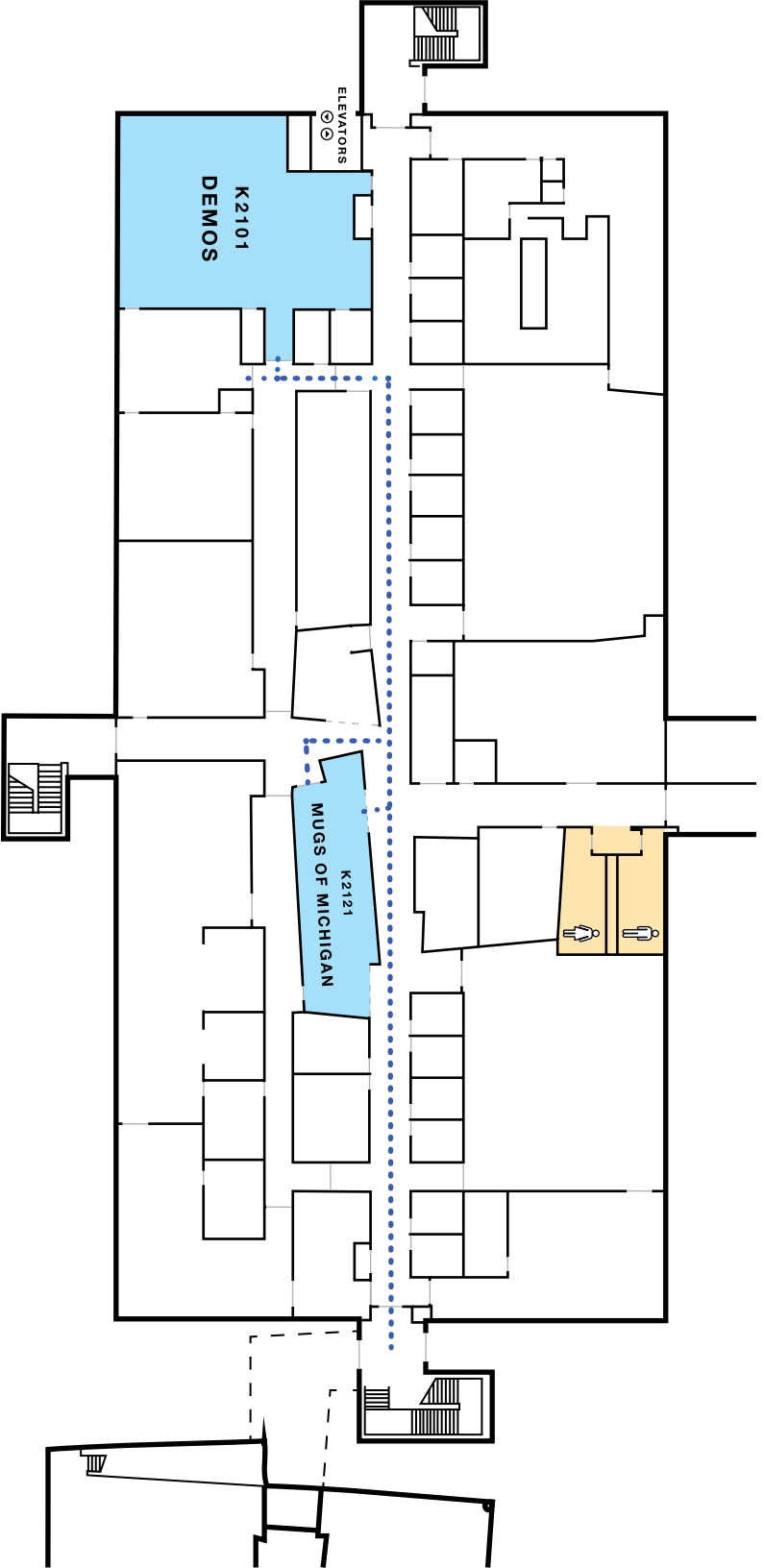

# SOUTH KOHRMAN FIRST FLOOR

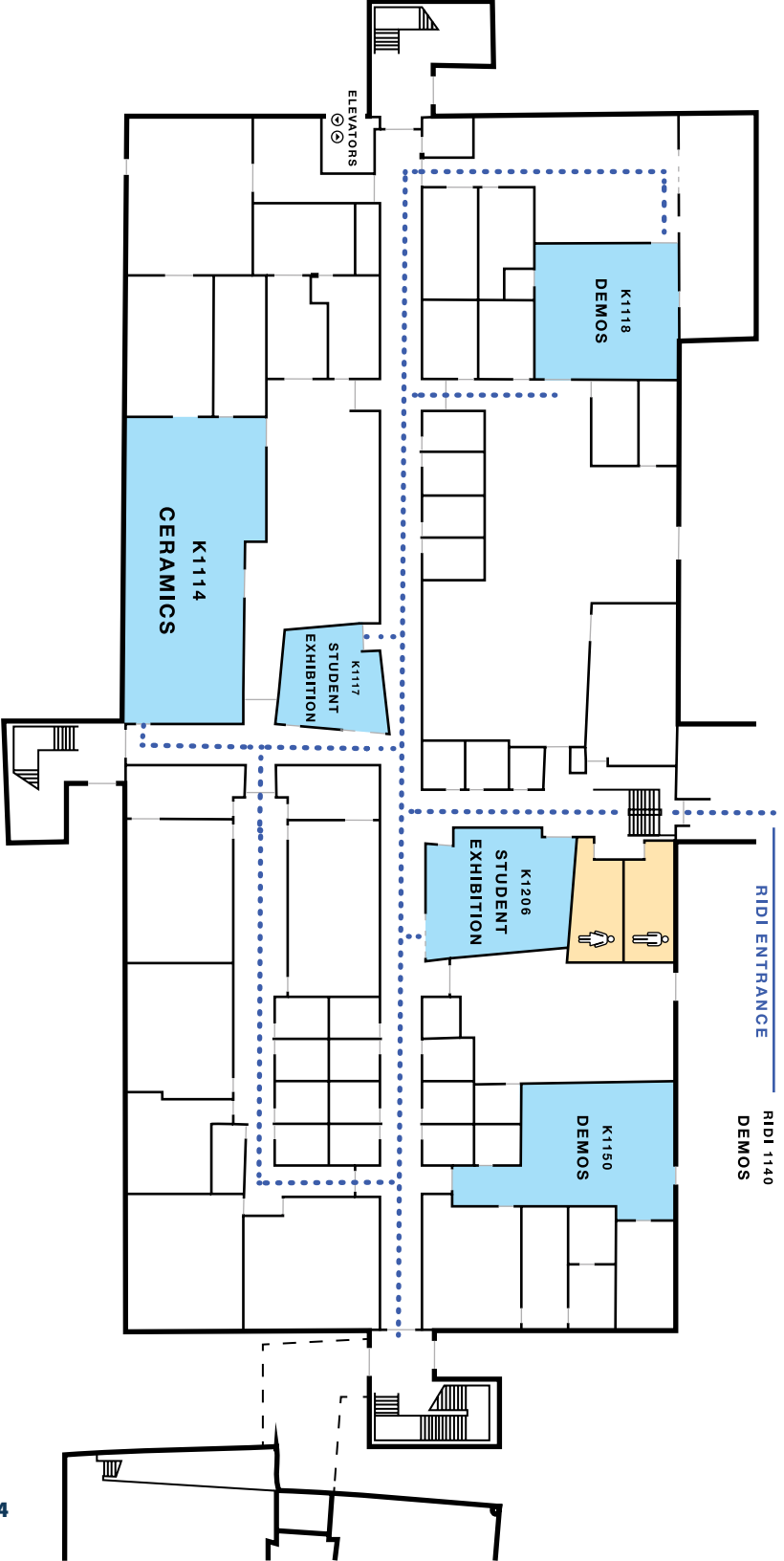

# FRI. / MAY 16 SCHEDULE

South Kohrman Hall  
RIDI

Richmond Center for Visual Arts (RCVA)  
Western Michigan University Student Center

	8:00	8:30	9:00	9:30	10:00	10:30	11:00	11:30	12:00	12:30	1:00	1:30	2:00	2:30	3:00	3:30	4:00	4:30	
	<b>Conference Registration</b> RCVA / Lobby										<b>Lunch</b> WMU Student Center Floor 3 / Dining Center								
<b>DEMOS AND LECTURES</b>			<b>Julie Devers</b> RCVA / R2008		<b>Micah Lewis-Vän Sweezie</b> RCVA / R2008		<b>Steven Johnson</b> RCVA / R2008		<b>Lauren Kalman</b> RCVA / R2008					<b>Keynote Demos:</b> <b>Paul S. Briggs &amp; Kyungmin Park</b> RCVA / R1004					
							<b>Jacky Denaway</b> South Kohrman K1118							<b>Michael Lorsung</b> RCVA / R2008		<b>Henry Crissman</b> <b>Virginia Torrence</b> RCVA / R2008			
			<b>Melis Agabigum</b> South Kohrman / K1150																
			<b>Hedy Yang</b> South Kohrman / K2101				<b>Benjie Heu</b> South Kohrman K2101							<b>Susan McHenry</b> South Kohrman / K2101					
			<b>Jerry Berta &amp; Madeline Kaczmarczyk</b> RIDI / 1040				<b>Ricky Blanding</b> RIDI / 1040							<b>Israel Davis</b> RIDI / 1040					
<b>EXHIBITIONS</b>	<b>Michigan Mud 2025 Keynote Presenters Exhibition</b> RCVA / Kerr Gallery (Reception and Awards: 5:00pm–6:30pm)																		
	<b>Michigan Mud 2025 Presenters Exhibition</b> RCVA / Student Gallery (Reception and Awards: 5:00pm–6:30pm)																		
								<b>Michigan Mud 2025 Student Exhibition</b> South Kohrman / K1117 and K1206 (Reception and Awards: 5:00pm–6:30pm)											
								<b>Mugs of Michigan Cup Show and Sale</b> South Kohrman / K2121 (Reception and Awards: 5:00pm–6:30pm)											
			<b>Sponsors and Vendors</b> RCVA / Brown Gallery & R2107																

# SAT. / MAY 17 SCHEDULE

South Kohrman Hall  
RIDI

Richmond Center for Visual Arts (RCVA)  
Western Michigan University Student Center

	8:00	8:30	9:00	9:30	10:00	10:30	11:00	11:30	12:00	12:30	1:00	1:30	2:00	2:30	3:00	3:30	4:00	4:30	
	<b>Conference Registration</b> RCVA / Lobby								<b>Keynote Panel Discussion</b> WMU Student Center Floor 2 / Ballroom			<b>Lunch</b> WMU Student Center Floor 3 / Dining Center							
<b>DEMOS AND LECTURES</b>			<b>Keynote Demos: Paul S. Briggs &amp; Kyungmin Park</b> RCVA / R1004				<b>BREAK: Please Transition to the WMU Student Center for the Keynote Panel Discussion</b>							<b>Keynote Demos: Paul S. Briggs &amp; Kyungmin Park</b> RCVA / R1004					
				<b>Sarah Lindley</b> RCVA / R2008											<b>Shay Church</b> RCVA / R2008				
			<b>Blake J. Williams</b> South Kohrman / K1118												<b>Nathan Goddard</b> South Kohrman / K1118				
			<b>Amy Santoferraro</b> South Kohrman / K2101												<b>Henry Crissman &amp; Virginia Torrence</b> South Kohrman / K2101				
			<b>Heidi Fahrenbacher</b> RIDI / 1040												<b>Claire Thibodeau</b> RIDI / 1040				
<b>EXHIBITIONS</b>			<b>Michigan Mud 2025 Keynote Presenters Exhibition</b> RCVA / Kerr Gallery																
			<b>Michigan Mud 2025 Presenters Exhibition</b> RCVA / Student Gallery																
			<b>Michigan Mud 2025 Student Exhibition</b> South Kohrman / K1117 and K1206																
			<b>Mugs of Michigan Cup Show and Sale</b> South Kohrman / K2121																
			<b>Sponsors and Vendors</b> RCVA / Brown Gallery & R2107																

# EVENT CATALOG

FRIDAY, MAY 16

---

## Conference Registration

8:00am–12:50pm, 2:30pm–4:20pm / RCVA Lobby

## Welcome Breakfast

8:00am–9:00am / RCVA Lobby

Join us for coffee, tea, fruit and pastries. Sponsored by AMACO Brent.

## Sponsors and Vendors

9:00am–1:00pm, 2:30pm–4:30pm / RCVA Albertine Monroe-Brown Gallery & R2107

Visit the manufacturers and suppliers of the brands and products that ceramic artists know and love. Free material samples, vendor logo swag, and company representatives to share product benefits and features.

## Michigan Mud 2025 Keynote Presenters Exhibition

9:00am–6:00pm / RCVA Rose Netzorg and James Wilfrid Kerr Gallery

A survey of artwork from Keynote Presenters, Kyungmin Park and Paul S. Briggs.  
Reception: Friday, May 16, 5:00pm–6:30pm. Sponsored by Rovin Ceramics.

## Michigan Mud 2025 Student Exhibition

12:00pm–6:00pm / South Kohnman K1117 & K1206

A collection of student artworks from institutions of higher education throughout Michigan representing current trends within ceramic medium through explorations of materials, processes, and content. Sponsored by DiamondCore Tools.  
Reception: Friday, May 16, 5:00pm–6:30pm

## Michigan Mud 2025 Presenters Exhibition

12:00pm–6:00pm / RCVA Robert A. Devires Student Art Gallery

An exhibition showcasing works from the 23 invited presenting artists.  
Reception: Friday, May 16, 5:00pm–6:30pm. Sponsored by Rovin Ceramics.

## Mugs of Michigan Cup Show and Sale

9:00am–6:00pm / South Kohnman K2121

A showcase of mugs created by Michigan artists to support the educational programming of the Michigan Ceramic Art Association.  
Sponsored by Evenheat Kilns  
9:00am–11:30am: Mug Drop-off  
2:30pm–6:00pm: Mug Sale

## Julie Devers / Art Education, Community, and Collaboration: The Kalamazoo Institute of Arts

9:00am–9:50am / RCVA R2008 (Lecture)

Devers will provide a lecture on the topic of community and clay at the Kalamazoo Institute of Arts' Kirk Newman Art School. This community-based art center, housed within a prestigious Midwestern museum, offers a wide range of courses, strong student-instructor relationships, and a space for community, friendship, and artistic expression. In addition, Devers will discuss the Art School's exceptional anagama kiln, which draws students from near and far.

## Hedy Yang / Design in the Clouds: Slip Casting and Production Methods

9:00am–10:50am / South Kohnman K2101 (Demo)

Yang will demonstrate her signature designed cloud vases. In addition to creating and decorating the form, she will discuss how she markets her work.

## Jerry Berta / Merging Modern Technology with Practical Ceramic Techniques

9:00am–10:50am / RIDI 1040 (Demo)

Learn how to do virtual sculpting using Nomad Sculpt to create practical models, molds, jigs, stamps, and extrusion dies. A 3D resin printer will be used for detailed, fast printing. For best results, attendees should start using Nomad Sculpt prior to attending.

## Madeline Kaczmarczyk / Pattern and Design: Beaded Clay Surfaces

9:00am–10:50am / RIDI 1040 (Demo)

Kaczmarczyk will demonstrate how she incorporates glass on post-fired ceramic pieces. Utilizing 3-D modeled stamps and forms based on original drawings, Kaczmarczyk will begin by creating surface texture on a clay piece. She will then demonstrate how she attaches the glass beads to a finished piece post-firing. A discussion of Kaczmarczyk's inspirations and ideas can translate to anyone's body of work.

## Melis Agabigum / Ceramic Enameling 2D and 3D Wire Structures

9:00am–10:50am / South Kohnman K1150 (Demo)

This demonstration will be an overview on the basics of enameling (fusing glass) on metal. Discussions of various surface textures from under- and overfiring enamel will also be discussed in relation to flat and three-dimensional surfaces.

## Micah Lewis-Văn Sweezie / Vietnamese Ceramic Craft Culture

10:00am–10:50am / RCVA R2008 (Lecture)

Vietnamese ceramic production has persisted for over a millennium in Southeast Asia, withstanding numerous colonization and occupancies upon the land. Sweezie will provide an in-depth survey of Vietnamese ceramics highlighting history, culture, craft villages, and various production methods from this under-recognized community.

**Steven Johnson / Material Changes:  
Adapting and Updating Your Glazes and Clay Body**

11:00am–11:50am / RCVA R2008 (Lecture)

Ceramic materials come and go. Join Steven Johnson, General Manager at Rovin Ceramics (Ann Arbor, MI), for a presentation on how to make changes and substitutions to your favorite glazes and clay body and get an insider's perspective on the ceramics material industry and supply chain.

**Jacky Denaway / Jigger: Jollyng for Vessel Consistency**

11:00am–12:50pm / South Kohrman K1118 (Demo)

For potters interested in reproduction, the jigger arm is a wonderful time saving tool. Participants will learn how to create profile forms that are then utilized to make plaster molds. Denaway will then demonstrate the process of plaster mold making with the jigger arm and how to use the mold to make bowls and plates.

**Benjie Heu / The Figure: Hollow Construction**

11:00am–12:50pm / South Kohrman K2101 (Demo)

Heu will demonstrate how to make a hollow hand-built head, figure, or animal/creature as well as his uses of underglazes to decorate surfaces.

**Ricky Blanding / Wheels of Change–Throwing Large Vases**

11:00am–12:50pm / RIDI 1040 (Demo)

Blanding will demonstrate his process of creating his large wheel-thrown vases. In addition, he will discuss his non-traditional path into ceramics and his ongoing social advocacy through his small business, Scrap Soils.

**Lauren Kalman /  
Identity and Performance: Clay Utilized as a Time-Based Material**

12:00pm–12:50pm / RCVA R2008 (Lecture)

Kalman will discuss her multimedia practice focused on performance and identity utilizing ceramics and pottery. Her conceptual work manifests as performance, video, vessels, garments, images, collaborative curatorial projects, and functional objects. The expansive opportunities for ceramic thinking are largely related to the connections between clay and the body. Kalman uses her body in both making and performing, with her body literally embedded in the ceramic object. She will discuss artworks that reframe and complicate historic interweavings of craft and the feminine body.

**Lunch**

1:00pm–2:30pm / WMU Student Center, Dining Center, Floor 3

Join us in the Dining Center for a variety of food options.  
Sponsored by AMACO Brent.

**Keynote Presenter Demonstrations:**

2:30pm–4:30pm / RCVA R1004

**Paul S. Briggs / Every Pinch Counts in Art and Life**

Paul S. Briggs will share his mindful approach to making hand-turned pottery, otherwise known as pinch pots. He will discuss how pinching clay is related to wheel throwing and will demonstrate how to achieve both low and high relief surfaces.

**Kyungmin Park / Containing Emotion–Hollow Built Figures**

Kyungmin Park will demonstrate a handbuilding technique for sculpting a human head. Beginning with the slab-building method to construct the basic structure, she will then refine it using coiling, pinching, and carving techniques to shape detailed facial features. Throughout the process, she'll discuss how figurative sculptures can effectively convey narratives and the significant role facial expressions play in storytelling through these forms.

**Michael Lorsung / Demystifying Kiln Data:  
Building a Community-Driven Digital Pyrometer**

2:30pm–3:20pm / RCVA R2008 (Lecture)

This presentation explores the journey of designing and building a robust, internet-connected, dual-input digital pyrometer for ceramic kilns. By breaking down the process in accessible terms, this talk aims to take the audience through the process of creating a digital pyrometer from open-source software and simple coding tools.

**Susan McHenry / Creating Personalized Templates for Slab Building**

2:30pm–4:20pm / South Kohrman K2101 (Demo)

McHenry will demonstrate how to make custom templates that can be used to build either simple forms or more complex stacked and darted pieces. She'll then construct a few forms to illustrate how the templates can be modified during the building process. Finishing details like feet, lugs, and handles will also be discussed.

**Israel Davis / The Ancient Future: Clay and Sound**

2:30pm–4:20pm / RIDI 1040 (Demo)

Music and clay are two of the most malleable, elastic, enduring, widely utilized, and shared materials. Davis will present his ceramic practice that delves into the making of percussion instruments with clay and rawhides. In addition, he will demonstrate the sounds and shapes that support his connection to past ceramic histories of instrument making and the communities they unite.

**Henry Crissman & Virginia Torrence /  
Building a Community Ceramics Studio and Artist Residency**

3:30pm–4:20pm / RCVA R2008 (Lecture)

Crissman and Torrence have spent the last eight years renovating their home and storefront in Hamtramck, Michigan, into what is now a vibrant community ceramics studio and residency space. Crissman and Torrence will share their story and lessons learned and discuss their teaching philosophies, personal art practices, visions for the future, and the necessity of community art spaces.



## Exhibition Receptions and Awards

5:00pm–6:30pm / RCVA Rose Netzorg and James Wilfrid Kerr Gallery, Eleanor R. and Robert A. DeVries Student Art Gallery, South Kohrman K1118, K1206, and K2121

Join us to view and celebrate the conference exhibitions: Michigan Mud 2025 Keynote Presenters Exhibition, Presenters Exhibition, Student Exhibition, and Mugs of Michigan Cup Show and Sale. Awards Ceremony will take place at 5:15pm.  
Sponsored by Rovin Ceramics.

## SATURDAY, MAY 17

---

### Conference Registration

8:00am–10:50am / RCVA Lobby

### Welcome Breakfast

8:00am–9:00am / RCVA Lobby

Welcome Breakfast Join us for coffee, tea, fruit and pastries.  
Sponsored by AMACO Brent.

### Keynote Presenter Demonstrations:

9:00am–10:30am, 2:30pm–4:30pm / RCVA R1004

### Paul S. Briggs / Every Pinch Counts in Art and Life

Paul S. Briggs will share his mindful approach to making hand-turned pottery, otherwise known as pinch pots. He will discuss how pinching clay is related to wheel throwing and will demonstrate how to achieve both low and high relief surfaces.

### Kyungmin Park / Containing Emotion–Hollow Built Figures

Kyungmin Park will demonstrate a handbuilding technique for sculpting a human head. Beginning with the slab-building method to construct the basic structure, she will then refine it using coiling, pinching, and carving techniques to shape detailed facial features. Throughout the process, she'll discuss how figurative sculptures can effectively convey narratives and the significant role facial expressions play in storytelling through these forms.

### Sponsors and Vendors

9:00am–11:00am, 2:30pm–4:30pm / RCVA Albertine Monroe-Brown Gallery & R2107

Visit the manufacturers and suppliers of the brands and products that ceramic artists know and love. Free material samples, vendor logo swag, and company representatives to share product benefits and features.

### Michigan Mud 2025 Keynote Presenters Exhibition

9:00am–4:30pm / RCVA Rose Netzorg and James Wilfrid Kerr Gallery

A survey of artwork from Keynote Presenters, Kyungmin Park and Paul S. Briggs.

## Michigan Mud 2025 Student Exhibition

9:00am–4:30pm / South Kohrman K1117 & K1206

A collection of student artworks from institutions of higher education throughout Michigan representing current trends within ceramic medium through explorations of materials, processes, and content. Sponsored by DiamondCore Tools.

### Mugs of Michigan Cup Show and Sale

9:00am–4:30pm / South Kohrman K2121

A showcase of mugs created by Michigan artists to support the educational programming of the Michigan Ceramic Art Association. Sponsored by Evenheat Kilns.

### Amy Santoferraro / Shopping is a Feeling

9:00am–10:50am / South Kohrman K2101 (Demo)

Objects can be charged with meaning, history, sentiment, and stories. Through her lifelong collection and cataloging of everyday objects found in thrift stores, dollar stores, and hardware stores, Santoferraro attempts to make sense of her surroundings through her interaction with the material world. She'll share images of her work, discuss her path and process of utilizing ceramic materials and popular culture components, and elaborate on how different places and materials present unique making opportunities and outputs.

### Heidi Fahrenbacher (Bella Joy Pottery) / Slip Cast Wares and Printed Surfaces for Functional Pottery

9:00am–10:50am / RIDI 1040 (Demo)

Heidi Fahrenbacher of Bella Joy Pottery will be demonstrating her technical process for using screen printing and slip casting forms. Through the use of these technical methods Heidi will share how this has developed her thriving and productive studio business.

### Blake J. Williams / Petals of Porcelain: Simple Mold Making for Multiples

9:00am–10:50am / South Kohrman K1118 (Demo)

Various hand building and mold making techniques with white clays for floral inspired ceramic and mixed media sculpture and installations.

### Sarah Lindley / After Evergood— Creating a Classroom Art Collective

10:00am–10:50am / RCVA R2008 (Lecture)

Professor Sarah Lindley will talk about her course Clay in Community and creating a classroom art collective where students worked together to create After Ever Good, a ceramic response to a problematic mural in the campus dining hall. The course is a research-informed hands-on clay class where students work collaboratively to develop large-scale ceramic projects in response to social issues. Course content includes socially-engaged and activist art practices, shared space, exchange, student experiences at Kalamazoo College, and initiatives to address/remove problematic art in public settings.

## Break

10:50am–11:30am

Please transition to the WMU Student Center Ballroom (2nd floor) for the Keynote Panel Discussion featuring Paul Briggs and Kyungmin Park.

## Paul S. Briggs & Kynungmin Park / Keynote Panel Discussion: Finding Your Community

11:30am–12:30pm / WMU Student Center, 2nd floor Ballroom

Moderated by Kyle Triplett, Director, Morean Ceramics Research Center at WMU

## Lunch

12:30pm–2:00pm / WMU Student Center, Dining Center, Floor 3

Join us in the Dining Center for a variety of food options.  
Sponsored by AMACO Brent.

## Shay Church / Installations and Disruptions

2:30pm–3:20pm / RCVA R2008 (Lecture)

Church will offer a presentation focused on his larger than life clay and wood installation series created between 2006-2019. These temporary clay installations have included life-size whales, elephants, wolves, and mythological creatures left to fall apart in abandoned buildings, parking lots, outdoor spaces, and galleries. Church will discuss how the series evolved, as well as the groups, organizations, spaces, and scenarios he collaborated with along the way.

## Virginia Torrence & Henry Crissman / Improvisational Pottery

2:30pm–4:20pm / South Kahrman K2101 (Demo)

Join Torrence and Crissman for a dueling wheel throwing demonstration where they'll discuss and exhibit their unique approaches toward throwing and altering vessels.

## Claire Thibodeau / Intricate Forms and Surface

2:30pm–4:20pm / RIDI 1040 (Demo)

Dive into an array of surface design techniques, concentrating on both wheel-thrown and slip-cast forms. Thibodeau will explore intricate surface treatments, sharing her methods and the diverse materials she employs to develop rich, layered imagery.

## Nathan Goddard / Painter's Palette: Mono-Print Transfers on Clay

2:30pm–4:20pm / South Kahrman K1118 (Demo)

Goddard will demonstrate how to create Mono-Print Transfers and quick draw screen printing using Speedball Underglazes, with wheel throwing and altering techniques.

# OUR SPONSORS



**WESTERN MICHIGAN UNIVERSITY**  
Morean Ceramics Research Center





MCAA  
**Michigan  
Mud 2025**  
KALAMAZOO, MI



**POTTERY LANE**  
STUDIO & SUPPLY